



File Name: canon sx120 is manual free download.pdf

Size: 3663 KB

Type: PDF, ePub, eBook

Category: Book

Uploaded: 30 May 2019, 12:31 PM

Rating: 4.6/5 from 647 votes.

Status: AVAILABLE

Last checked: 19 Minutes ago!

In order to read or download canon sx120 is manual free download ebook, you need to create a FREE account.

[Download Now!](#)

eBook includes PDF, ePub and Kindle version

[Register a free 1 month Trial Account.](#)

[Download as many books as you like \(Personal use\)](#)

[Cancel the membership at any time if not satisfied.](#)

[Join Over 80000 Happy Readers](#)

Book Descriptions:

We have made it easy for you to find a PDF Ebooks without any digging. And by having access to our ebooks online or by storing it on your computer, you have convenient answers with canon sx120 is manual free download . To get started finding canon sx120 is manual free download , you are right to find our website which has a comprehensive collection of manuals listed.

Our library is the biggest of these that have literally hundreds of thousands of different products represented.



Book Descriptions:

canon sx120 is manual free download



Canon PowerShot SX120 IS boasts a powerful 10x 36360mm optical zoom lens bring faraway subjects closer. The Optical Image Stabilizer reduces the effects of camera shake and blur, your photos are steady and crystal clear, even at high zoom. The 10 MP CCD sensor combines with the stateofheart DIGIC 4 Image Processor delivers detailed images for postertime prints or creative cropping. The PowerShot SX120 IS features Smart AUTO mode, which intelligently analyzes your situation and shooting conditions, and deciding the optimum settings for the best result, taken from a choice of 22 different scene types. Other highlights include 3inch LCD screen, Full Manual Control, Easy Mode, Face Detection, Redeye Correction and iContrast optimizes dynamic range, retaining detail in shadows and preventing overexposure of highlights. Camera User Guide. If there is a problem with the camera while abroad, please return it to the country of sale before proceeding with a warranty claim to a Canon Customer Support Help Desk. For Canon Customer Support contacts, please see the customer support list supplied with your camera. Chapters 4 onward explain the advanced functions, letting you learn more as you read each chapter. Checking the Package Contents.2 Read This First.3 What Do You Want to Do.4 Conventions Used in this Guide.8 Safety Precautions.9. The latter part of this chapter explains how to shoot and view images in Easy Mode, how to shoot and view movies and how to transfer images to a computer. The memory card will pop up. Compatible Batteries AAsize alkaline batteries and Canon AAsize NiMH batteries sold separately pp. 38, 40. Can any other batteries be used. We cannot recommend the use of any other batteries than those listed above because performance varies widely. Can you check the number of shots that can be taken. You can check the number of shots that can be taken when the camera is in a Shooting mode p.<http://kokboken.se/media/dvr-avermedia-manual.xml>

- **canon sx120 is manual free download, canon sx120 is manual free download windows 7, canon sx120 is manual free download windows 10, canon sx120 is manual free download free, canon sx120 is manual free download pc.**

Canon

PowerShot SX120 IS **Gebruikershandleiding**



NEDERLANDS

- Lees voordat u de camera gebruikt eerst deze handleiding door.
- Bewaar de handleiding, zodat u deze later nog kunt raadplegen.

Since the dates and times recorded into your images are based on these settings, be sure to set them. Enter Playback mode. Press the 1 button. To take images that are in focus, be sure to first press the shutter button lightly halfway to focus, then take the shot. The camera can also detect and focus on faces, setting the color and brightness to optimal levels. Pressing the l button while turning on the camera power will turn off all sounds except for warning sounds. The subject is too far away for the flash to reach. Enter Playback mode. Please note that erased images cannot be recovered. Exercise adequate caution before erasing an image. Enter Playback mode. Choose an image to erase. Choose an image to print. Shooting Time Choose E mode. Enter Playback mode. Transferring Images to a Computer Install the software. Windows Place the DIGITAL CAMERA Solution Disk in the computer's CDROM drive. Macintosh CameraWindow will appear when you establish a connection between the camera and computer. AV Cable AVCDC400 Interface Cable IFC400PCU Memory Card DIGITAL CAMERA Solution Disk AC Adapter Kit ACK800 Compact Power Adapter CAPS800 Power Cord. This product is designed to achieve excellent performance when used with genuine Canon accessories. Some accessories are not sold in some regions, or may no longer be available. P, Tv, Av, M Mode You can make settings such as the shutter speed and aperture value in order to take the picture you want. However, the brightness of the image on the screen, and the brightness of the actual image recorded may be different. The menu items are organized under tabs, such as for shooting 4 and playback 1. Muting Sounds Adjusting the Volume Display the menu. Change the brightness. Are there functions that cannot be reset. Formatting initializing a memory card erases all data on the memory card. As you cannot retrieve the erased data, exercise adequate caution before formatting the memory card. <http://cresson-voyages.com/userfiles/dvr-7116-manual.xml>



Power Saving during Shooting The monitor will turn off approximately 1 minute after the camera is last operated. All you need do is press the shutter button to take an optimized picture. Shooting in Special Scenes The camera will select the necessary settings for the conditions in which you wish to shoot when you choose the matching mode. Digital TeleConverter The focal length of the lens can be increased by an equivalent of 1.4x or 2.3x. Once inserted, however, they cannot be deleted. The camera will activate approximately 10 seconds after the shutter button is pressed. You can change the delay time and number of shots p. 75. Press the p button. Even if your face is not detected after joining the subjects, the shutter will release approximately 30 seconds later. AE stands for Auto Exposure. What if the shutter speed and aperture value are displayed in orange. If a correct exposure cannot be obtained when pressing the shutter button halfway, the shutter speed and aperture value are shown in orange. If you choose Converter p. 61. Changing the Compression Ratio Image Quality You can choose from the following two levels of compression ratio image quality Fine, Choose the recording pixels. Fine weather conditions, outdoor shooting. Auto Automatically sets the optimal white balance for the shooting conditions. Day Light Fine weather conditions, outdoor shooting Cloudy Cloudy, shady, twilight conditions Tungsten Tungsten, bulbtype 3wavelength fluorescent lighting Warmwhite fluorescent, coolwhite fluorescent, warmwhitetype. My Colors Off Vivid Neutral Sepia Custom Color The white balance cannot be set in the Choose My Colors. Changing the Composition with the Focus Lock While you keep the shutter button pressed halfway, the focus and exposure. What if the display does not magnify. After locking the focus, the focal distance will not change even when you release your finger from the shutter button.

Confirming the number of detected faces Keeping the 0 button pressed will display the number of faces detected by the camera 35 at the most orange main subject's face, white detected face. Evaluative Center Weighted Avg. Spot Choose the Metering mode. AE stands for "Auto Exposure". FE stands for "Flash Exposure". At the same time, you can use a slow shutter speed to brighten the background that the light from the flash cannot reach. The camera will set the appropriate aperture value for the shutter speed you set. M stands for "Time value". The camera will set the appropriate shutter speed for the aperture value you set. B stands for "Aperture value". D stands for "Manual". Also, when the overall image is lacking in contrast, the camera will automatically correct the image for a sharper impression when shooting. Redeye correction may be applied to red areas other than red eyes. The latter part explains how to specify images for printing. Move the zoom lever toward g. Images will display in an index. The number of images increases each time you move the lever. If you keep the qr buttons pressed, you can fast forward through images. Protected images cannot be erased with the camera's erase function. To erase an image, cancel protection first. Since erased images cannot be recovered, exercise adequate caution before erasing. Protected images p. 106 cannot be erased. Also, when the overall image is lacking in contrast, the camera will automatically correct the image for a sharper impression. You can then print all the chosen images at once or take the memory card to a photo developer to order prints. Make print settings. The first part of this chapter explains convenient and commonly used functions. The latter part explains how

to change shooting and playback settings to suit your purposes. Changing the Lens Retract Time For safety reasons, the lens retracts about 1 minute after pressing the 1 button when in a Shooting mode p.

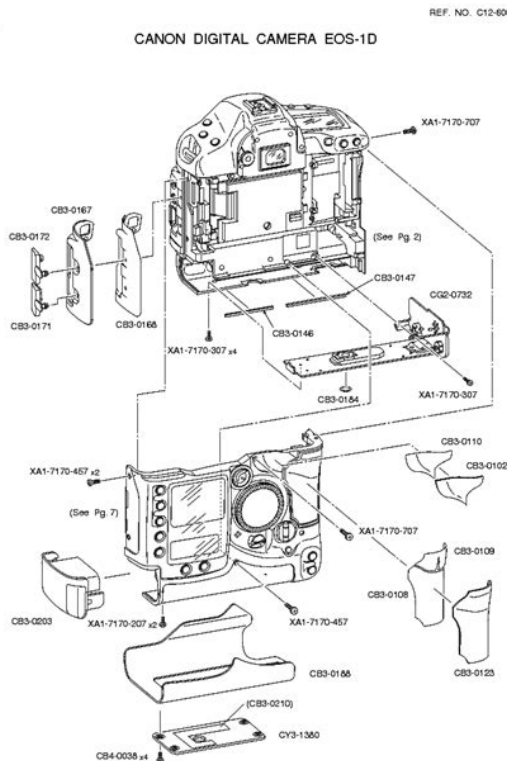

<http://schlammatlas.de/en/node/18390>

Changing Distance Units You can change the distance units that display in the zoom bar pp. 22, 60 and the MF indicator p. You can turn off this function. Changing the Image Display Time You can change the length of time the images display directly after shooting. Last seen Resumes with the image last viewed. The index also appears at the end. Do not unplug the plug and power cord with the camera turned on. This could erase images you have taken or damage the camera. If the items below do not solve your problem, contact a Canon Customer Support Help Desk as listed on the included customer support list. Power You pressed the power button, but nothing happened. Press the power button to turn the camera off and back on p. 42. If this error message continues to appear, contact your Canon Customer Support Help Desk as there may be a problem with the lens. Erase all Erases images. Protect Protects images. Rotate Rotates images. Corrects dark portions and contrast in still iContrast images. RedEye Correction Corrects red eyes in still images. Resize Resizes and saves still images. With this Table of Content, you can directly go to the certain part of this article simply by clicking the sub topic below. Contents show 1 An Introduction to Canon PowerShot SX120 IS Manual 1.1 The Overall Look of Canon PowerShot SX120 IS 1.2 The Specification of Canon PowerShot SX120 IS 1.3 The Price and Impression of Canon PowerShot SX120 IS 2 Canon PowerShot SX120 IS Manual User Guide An Introduction to Canon PowerShot SX120 IS Manual It is such a perpetuation that a product, especially for the digital camera product, can't be separated from its manual. By using this manual, user will be able to understand about their product deeper. Therefore, operating and treating the camera better will be something possible. This is exactly why we provide the Canon PowerShot SX120 IS Manual.

DIAGRAM 1 High Level Connections

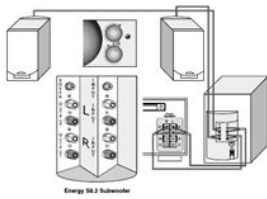

DIAGRAM 2 Using the Subwoofer Output of an A/V Receiver or Processor

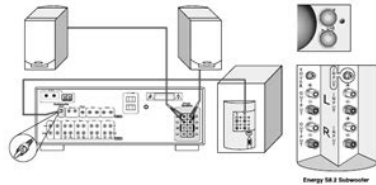
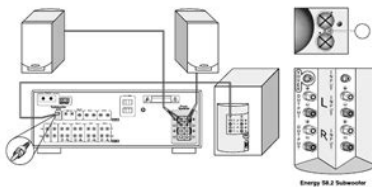

DIAGRAM 3 Using an External Crossover



The only aim is to educate the users of this camera to use this product better so that they can result a good photographical image. The Overall Look of Canon PowerShot SX120 IS It is generally known that look is something important that becomes a consideration for people in buying digital camera product. With the look, People can instantly attracted to a certain digital camera product. More than that, sometimes the choice of camera look is also reflecting the personality of owner as well as the classiness of the camera itself. So, before we hit the Canon PowerShot SX120 IS Manual User Guide directly, now we are going to talk about the look of this camera first. Actually, there is no significant change from product's appearance. It comes with all black domination with white wording in several parts. You can't deny that this camera represents bold and solid soul. Canon PowerShot SX120 IS manual tells that it has 111 x 71 x 45 mm body dimension. Therefore, Canon PowerShot SX120 IS will be easy to handle. Moreover, the magnesium alloy as the body material will resist against wear, tear, and drop. If you are trying to figure it out, the overall body weight is just approximately 245 gram. It is such a proportional camera body, because it is not too small or too big. Read another review of this camera in this link. The Specification of Canon PowerShot SX120 IS A midsize digital might be the most suitable option for those willing something practical but with high specification. There are tons of products out there, but there is nothing like Canon PowerShot SX120 IS. Manufactured under Canon U.S.A, this camera offers better performance than its predecessor, Canon PowerShot SX110 IS. Get closer with this camera as detailed below. The first thing to be underlined is that this cool camera comes with 10 megapixels sensor resolution. No need to bring additional gadget for video recording because Canon PowerShot SX120 IS also doing well for this duty.



The RGBG software is set to be the main color filter technology. No wonder that the colors will be as alive as possible. On the lens and optics sectors, the manufacturer put their trust on Canon Zoom Lens. This type of lens has focal length at 36360 mm with maximum aperture at f2.8f8.0. You can do more with its 10X Optical Zoom. Nothing too difficult in applying several settings because you are able to make it live from its 3 inches LCD Display. Several software are set to support your photography activity such as Canon ImageBrowser, Canon remote Capture, Canon PhotoStitch, and Canon ZoomBrowser. Last but not least, double AA NiMH batteries are required to supply this camera's power. The Price and Impression of Canon PowerShot SX120 IS Overall, Canon PowerShot SX120 IS has what it takes to be a great midsized camera. Mary Kate, one of the users, said that she loves this camera for its image stabilizer, fast shutter speed, small size, and decent price. Now it's the right time for you to try. Get it at 249 USD and you will never regret. Canon PowerShot SX120 IS Manual User Guide As it is stated at the beginning of this article, the aim of providing this writing is to bring the Canon PowerShot SX120 IS Manual. This is the manual that will give you the information related to the specification, features, operation, instruction, camera manual, and others. So, for you who want to look for information regarding to this Canon camera product, referencing to the manual below will be the best thing to do. To give you the better access, we will provide the manual in PDF. So, before reaching out to the manual, it will be better if you download the PDF reader software first. Download Canon Camera PowerShot SX120 IS Manual Read other Canon camera manual user guide in this page. Find more Camera user manual several other brands in this page. That's all of the information related to the Canon PowerShot SX120 IS Manual.

We hope that the information below could be beneficial to update your understanding toward this camera product. If you have any thoughts about this product in general, we welcome you to put them in the comment session below. And if you find this information is useful, sharing this article in your personal page will be so much appreciated. Share Pinterest Tweet Linkedin Email Prev Article Next Article Related Articles Canon EOS Digital Rebel Manual User Guide Canon PowerShot A1300 Manual for Tiny Compact Camera with Gigantic Superiority Leave a Reply Cancel reply This site uses Akismet to reduce spam. Learn how your comment data is processed. By continuing to use this website, you agree to their use. Please consider supporting us by disabling your ad blocker. Refresh. This page requires Javascript. Modify your browsers settings to allow Javascript to execute. See your browsers documentation for specific instructions. To install your download click on the name of the downloaded file. Access your account, or create a new account, click here to get started. Figures for Movie Mode represent total capacity of the particular media. However, protected images cannot be erased Movie any movie file files must be erased one at a time Recommended Software File Name Date File Size Optional Software File Name Date File Size Recommended Manuals File Name Date File Size Optional Manuals File Name Date File Size The Product purchased with this limited warranty is the only PowerShot Digital Camera to which this limited warranty applies. Warranty exchange or replacement does not extend the original warranty period of the Product. The sole warranty, if any, with the respect to such nonCanon brand items is given by the manufacturer or

producer thereof.

<https://inclinedigital.com/wp-content/plugins/formcraft/file-upload/server/content/files/16272f6f8c407b---briggs-and-stratton-17-hp-ohv-manual.pdf>

This limited warranty covers all defects encountered in normal use of the Products, and does not apply in the following cases A Canon Customer Care representative will attempt to diagnose the nature of the problem and correct it over the telephone. If the problem cannot be corrected over the telephone, you will be asked to follow the applicable procedures for MAILIN SERVICE. Note that a dated proof of purchase is required at the time of service. MAILIN SERVICE is a program under which your Product is repaired by a Canon U.S.A. or a Canon Canada authorized service center for the Product. You will be given the name, address and phone number of an authorized service center. It is your responsibility to properly package and send the defective Product, together with a copy of your dated proof of purchase, a complete explanation of the problem and a return address to the authorized service center at your expense. Do not include any other items with the defective Product. The Product covered by this limited warranty and proven to be defective upon inspection will be repaired and returned to you without charge by the authorized service center. Any Product received by the authorized service center that is not covered by the limited warranty will be returned unrepaired, or at the discretion of the authorized service center, you may receive a written estimate of repair at such cost as the service center may establish from time to time. Scroll down to easily select items to add to your shopping cart for a faster, easier checkout. Visit the Canon Online Store Provides uninterrupted power for shooting or downloading. It allows viewing of recorded images from the Canon Powershot Digital Cameras. Effectively doubles the flash range of the camera. Comes with mounting bracket. The cable connects to your camera and to the USB port on your PC or MAC Computer.

Comes standard with the EOS 1Ds Mark III, 1D Mark IV, 1D Mark III, 1Ds Mark II, 1D Mark II N, 1D Mark II, 5D Mark II, 7D, 5D, 50D, 40D, 30D, 20D, 10D, Digital Rebel XTi, Digital Rebel XT and Digital Rebel. Please see Compatibility tab for compatible models. Checking the 26 Feb 2015 Canon PowerShot SX120 IS Camera User Manual, Instruction Manual, User Guide PDF. Free Download Canon PowerShot SX120 IS PDF Camera manuals and free digital camera pdf instructions. Find the user manual you need for your camera and more at ManualsOnline. Reading this guide will help you learn to use the camera properly. Organization of Camera User Guide. Adobe Reader is required to view the PDF manuals. Warranty. Card The images recorded with this camera are intended for personal use. Do not. Canon PowerShot SX120 IS Digital Camera Canon PowerShot SX120 IS User Guide Manual Download pdf. View and Download Canon Powershot SX120 IS user manual online. Canon Powershot SX120 IS User Guide. Powershot SX120 IS Digital Camera pdf manual PowerShot SX120 IS. Reload to refresh your session. Reload to refresh your session. Camera manuals and free digital camera pdf instructions. Find the user manual you need for your camera and more at ManualsOnline. Instructions in this guide apply to the camera under default settings. Download drivers, software, firmware and manuals for your Canon product and get access to online technical support resources Canon PowerShot SX120 IS. View and Download Canon Powershot SX120 IS user manual online. Canon Powershot SX120 IS User Guide. Powershot SX120 IS Digital Camera pdf manual 5 Oct 2009 9 Oct 2009 Canons SX series of PowerShot cameras this year are a lot like last the SX120 IS are a 10x optical zoom, a 3.0 inch LCD, manual control, Burlaci intarziati 2013, Rave master subtitle indonesia indowebster abdccfc, Landscaping guide, Glen dorsey nfl contract, Sample nmr spectra. Reload to refresh your session. Reload to refresh your session.

Also, you will not have to worry about your website going to sleep ever again! Your dream website is waiting for you! No hassle, no risk. Camera User. Page 2 Memory cards Cover Before use, make sure the following items are included in. Page 3 in This Guide Cover. Page 4 Cover Page 9 Cover. This could result in electrical shock. Page 10 Cover. Page 11 Basic Guide Cover Page 12 Charging

CoverPrepare for shooting as follows. Page 13 Inserting the Battery Pack and Memory Card
 CoverInserting the Battery Pack and Memory CardPage 14 CoverRemoving the Battery Pack and
 Memory Card Before UseSet the current date and time. Page 16 Display language CoverStill Images
 MoviesPage 18 CoverPage 20 Cover. TouchScreen OperationsPage 21 Camera Basics CoverPage 22
 Power saving CoverPage 23 Shooting Modes CoverTo ensure your shots are in focus, always begin
 by holding the. Page 24 Basic operations CoverMenu Before Use. Press the button to view other
 information on. Page 25 Basic operations CoverUsing Menus Before UsePage 26 CoverTouchScreen
 Operations Before UsePage 27 OnScreen Keyboard CoverUse the onscreen keyboard to enter. Page
 28 Indicator CoverPage 29 Hybrid Auto Mode CoverPage 30 Shooting Smart Auto CoverPage 31
 CoverPage 33 Cover. Display. Page 34 Scene Icons CoverPage 35 Image Stabilization Icons CoverIf
 you shoot a still image when. Page 36 Digital zoom CoverPage 39 Touch Shutter CoverPage 40
 Adding date stamps CoverPage 41 Face ID CoverIf you register a person ahead of time, the. Page 42
 CoverPage 44 Checking and Editing Registered Information Cover. Checking and Editing Registered
 Information 3 Check or edit the information as Before UseYou can overwrite existing. Page 46
 Aspect ratio CoverYou can erase information face info, names, birthdays registered to. Page 47
 Resolution image size CoverChoose from 4 levels. Page 48 Mercury lamp correction CoverPage 49
 Electronic level Cover. Page 50 Blink detection CoverThe Checking for Closed Eyes Before.

Page 51 Lamp CoverCustomize shooting functions on the MENU. Page 52 Display period CoverPage
 54 Underwater shooting mode CoverChoose a mode matching the shooting scene, and the camera
 will Shoot. Page 55 Underwater Macro focusing range CoverPage 56 Super vivid shooting mode
 CoverAdd a variety of effects to images when shooting. Page 57 Nostalgic shooting mode CoverPage
 58 Miniature effect shooting mode CoverPlayback Speed and Estimated Playback Time Shooting
 with a Toy Camera Effect Before UsePage 61 Monochrome shooting mode CoverShoot. Page 62
 Wink selftimer shooting mode Cover. Page 63 Face selftimer shooting mode CoverPage 65 shooting
 mode CoverPage 67 movie mode CoverPage 68 CoverPage 70 Program AE CoverPage 71 Metering
 method CoverLinking the Spot AE Point Frame to the. Page 73 High ISO NR CoverTone down. Page
 76 White balance color CoverPage 78 Sepia tone images CoverPage 81 MF peaking CoverPage 84
 Servo AF CoverThis mode. Page 85 Face select CoverPage 86 Touch AF CoverThe focus can. Page
 88 Slow synchro CoverFires automatically in lowlight conditions. Common. Page 89 FE lock
 CoverJust. Page 90 RAW CoverPage 91 Compression ratio image quality CoverPage 93 5 Tv, Av, M,
 and C Mode CoverPage 94 Tv shooting mode CoverPage 96 Ring function selector button
 CoverChoose. Page 97 C shooting mode Cover. Page 98 Customizing Display Information CoverPage
 100 FUNC. menu layout CoverMenu 3 Configure the setting. Page 104 Viewing CoverPage 105
 CoverPage 106 Switching Display Modes CoverPress the button. Page 107 Still Images Digest
 Movies CoverRGB Histogram, GPS Information Display Still. Page 108 Index display CoverDigest
 movies can be viewed by date. Still Images. Page 109 Image search CoverPage 110 CoverStill
 Images Before UsePage 113 Magnified display CoverImage Viewing Options Before UseTouchScreen
 OperationsPage 115 Smart Shuffle CoverProtect important images to prevent accidental erasure by.
 Page 117 Selecting a Range Cover.

Selecting a Range zzSpecifying All Images at Once Still Images MoviesYou can choose multiple
 images to erase at. Page 120 Rotating CoverSelecting a Range Rotating Images Before Use.
 Common CameraFollow these steps to deactivate automatic image rotation, which rotatesStill
 Images MoviesPage 123 Changing Touch Actions Functions CoverSimplify your preferred camera
 operations by reassigning dragging patterns Favorites. Page 124 Resizing images CoverPage 125
 My Colors CoverPage 127 Redeye correction CoverMovie file sizes can be reduced by compressing
 movies. Page 130 WiFi functions CoverPage 132 images CoverSending images via WiFi requires.
 Page 133 Sending images to a printer CoverPage 134 Registering CANON iIMAGE GATEWAY
 CoverAfter linking the camera and CANON iIMAGE GATEWAY. Page 135 CoverYou can also add Web
 services besides CANON. Page 137 Installation CoverPrepare to register a computer. To save

images. Page 138 CoverPage 139 WiFi menu CoverPage 140 Connecting via an access point
CoverPage 141 Cover. Check sheet Connecting to WPSCompatible Access PointsPage 142 CoverYou
can reconnect to any previous access. Page 145 Camera access point mode CoverPage 146 Previous
Access Points CoverPrevious Access PointsPage 147 Connecting to Another Camera CoverPage 148
Sending images Cover. Send images wirelessly. Page 149 Adding Comments Cover. Only one movie
can. Page 150 Saving images to a computer Cover. Page 151 Image Sync CoverPage 153 information
CoverGPS data recorded on a smartphone. Page 154 CoverErasing Connection Information Before
UsePage 155 Returning the WiFi Settings to Default CoverReturn the WiFi settings to default if you
transfer ownership. Page 156 Setting Menu CoverPage 157 Sounds CoverHints and tips are
normally shown when you choose FUNC. Page 159 Eco mode CoverThe lens is. Page 160 Formatting
Memory Cards CoverAdjust screen brightness as follows. Before using a new memory card.Instead
of saving images in folders created each month, you.

Page 163 Deactivating TouchScreen Operations CoverThe touchscreen can be disabled to. Page 164
Adjusting Other Settings CoverYou can delete both the author's name and copyright details. Page
165 Reset all CoverIf you accidentally change a setting, you can restore default cameraPage 167
System Map CoverThe following camera accessories are sold separately. Note that
availabilityPrinters Still Images MoviesPage 171 Stereo AV cable CoverPage 173 Computer
Connections via a Cable CoverThe software available for download from the Canon. Page 174 Saving
images to a computer CoverWindows 7 and Mac. Page 175 Cover. CameraWindow. Page 176
Printing CoverChoosing Paper Size and Layout before Printing zzPrinting ID Photos Common
CameraClearing All Images from the Print List Adding Images to a Photobook Before Use. Page 183
CoverAdding Images IndividuallyPage 186 Cover. No AF frames are displayed and the camera does
not focus when the Subjects are affected by redeye. Page 187 Cover. Zooming is not possible.
Computer. Cannot transfer images. Page 188 Error messages Cover. Cannot connect to the access
point. Page 189 Cover. Page 190 Cover. WiFi Receiving failedConnection failed. Page 191 Level
CoverPage 192 Playback Detailed Information Display CoverPage 193 Table CoverFunction Common
Camera. Page 195 Table CoverFunction Common Camera. Page 197 CoverFunction Common
Camera. Page 198 4 Shooting Tab Menu CoverFunction Common Camera. Page 200 CoverFunction
Common Camera. Page 201 CoverFunction Common Camera. Page 202 CoverFunction Common
Camera. Page 203 My Menu Tab Menu CoverAvoid dropping it or Camera. Page 205 CoverPage 206
Recording time CoverPage 207 CoverPage 209 Cover. Hybrid Auto shooting mode. 32 Movies R
ShootingTv shooting mode. 94Underwater Macro focusing range. 55 Operations. Underwater
shooting mode. Page 211 Precautions CoverPage 213 CoverPage 214 Cover. FCC NoticeDisclaimer
Before Use.

<http://eco-region31.ru/bosch-starter-motor-repair-manual>